



 rcona 410

Arcona 410

We are proud to welcome you to Arcona Yachts – a Swedish boat builder with the ambition to lead the development of true sailing boats for the whole family. With the help of our designer, Stefan Qviberg, we began in the early 1990s to develop and refine a concept that combined wonderful sailing ability with a high degree of comfort and safety. All done with the best quality Swedish workmanship. To build a boat without compromise costs money but in Arcona Yachts price is not our prime consideration, which allows us to appeal to those who choose the best in life. Welcome to the world of Arcona.

We want to give you the opportunity to set sail in a fresh breeze knowing that the boat will look after you and your family in the waves and wind. But we also want you to be able to set out with a race crew and win Club races or big regattas.

We who work at Arcona Yachts love sailing and are very proud of our boats. Our inspiration and driving force therefore stems from the joy of realising the dream of building better and better boats and experiencing the feeling of being at the forefront of development. We are delighted to invite you to experience our most popular boat – the Arcona 410.







Swedish quality

During the production process of a new boat there are thousands of different decisions and detailed questions: Which material shall we use? Size of the fittings? Quality of the ropes? Consistently the answer is to choose what is best for the boat we are building.

The decision making process for us is simple – we want a boat that we can be proud of. The hull is stiff and strong, the rig can be set with the right tension and the boat is safe and secure in all its detail.

Our Swedish heritage shows in the beautiful lines and clean and functional design; classic Swedish boat building tradition with satin-finished mahogany and fine textiles. Bright, beautiful, functional and with lots of hidden quality, something you will appreciate more and more each year with your Arcona 410.





Hand-picked suppliers

Choosing sails and sail lofts opens up a world of possibilities. Durability and function, wrestle with performance, racing and trimming possibilities. How many sails do you have? Spinnaker or Code 0? What suits your crew and how will the boat be sailed? Our nominated sail makers know our boats, have all the expertise, the latest technology and dedicated support.

Electronic Instruments with all the latest technological advances are a more difficult nut to crack. AIS, WiFi, TV – what will you choose? B & G is the market leader and main supplier of instruments to our boats.

Selden is the leading producer of Masts and deck fittings, with branches across the world – the choice is simple and obvious.

Harken manufactures winches, which like our boats, combine functionality, quality and design.

Yanmar is the supplier of our engines. A wide assortment and an international service network with instant feedback when needed.

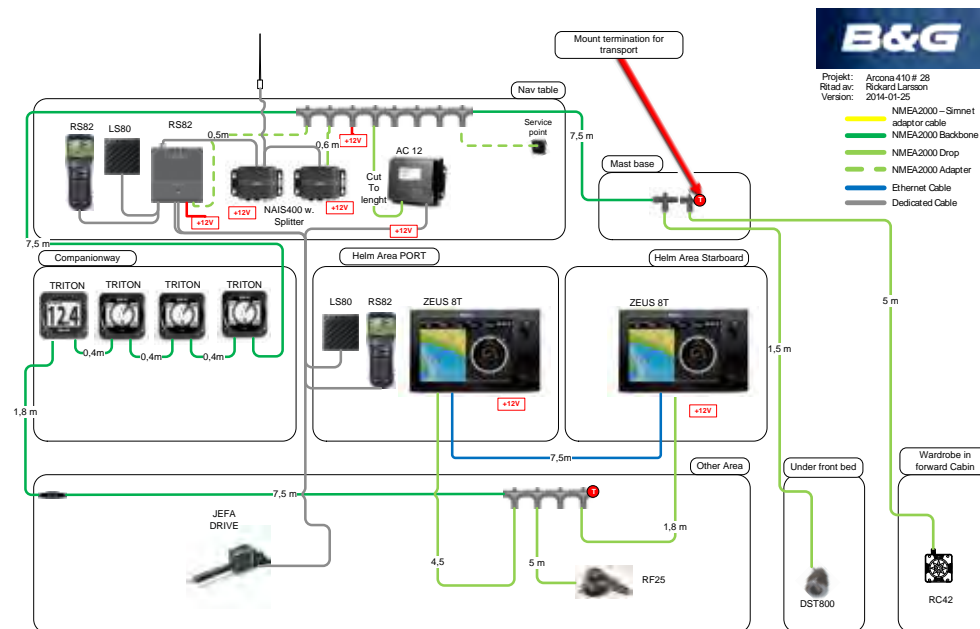



Sailing the Arcona 410

What is the ideal size for a sailing yacht? You will want enough berths for everyone, good standing headroom and a spacious saloon. You will want a delightful sailing experience and a boat that is agile and easy to manoeuvre. One that is easily handled by two people, but with room for friends and family.

Many Arcona sailors believe that 41feet is the perfect size.

The beautiful lines of the Arcona 410 show how well she will sail. She is a boat that is beautifully balanced, a joy to handle and produces sparkling performance. Experience the feel and responsiveness of the boat to the helm. With the sheets and control lines all to hand in the cockpit she is easy to sail short-handed. The twin wheels on the Arcona 410 make it possible to sit well to windward with a clear view of the sails, whilst the spacious cockpit has room for the whole crew when in harbour.

One doesn't like to brag about sailing past other boats on the water – but hand on heart, it is a nice feeling!















Interior and comfort

The Arcona 410 has a spacious saloon with lots of natural light. The classic galley is easy to work in, both at sea and in harbour. All the berths are full length and wide. Indeed the forepeak is so wide that you can sleep with your head forward. The heads with its wet locker, toilet and shower are well arranged.

The engine and tankage are easily accessed.

The high quality of our workmanship and finish is something of which we are justly proud. Spending a day below in bad weather in an Arcona becomes a pleasure.

The Arcona 410 is available with a number of different lay outs. Two or three cabins, heads with a separate shower, additional heads in the forepeak. Much of the boat is standard, but many possibilities exist for personalisation.

The cockpit table has room for everyone. Thanks to the twin wheels, access to the cockpit is easy and welcoming.





Service and Support

We take a great interest in our Arcona owners, and are proud of the level of support that we give them once they have taken delivery of their new boat. As well as several local Arcona Owners' Associations', which has an active programme of events, we provide many of our owners with advice and assistance with regard to such things as new sails, winter maintenance and installing additional equipment.



This is the way we build our Arcona Yachts

All Arcona Yachts are built in accordance with the European CE-regulations, approved and classified in Category "A". The hull and deck are a vacuum bagged sandwich construction with multi axial rovings and Vinylester resin. The core material is 20 mm Divinycell. Solid laminate is used for rudder, engine bed, keel attachment and all through hull fittings. We laminate the bulkheads to the hull and deck giving the construction superb strength and rigidity.

The deck is bonded to the hull with Vinylester glue, giving the strongest possible bond and torsional rigidity. At the heart of the Arcona 380 is a galvanised steel cradle which takes all the dynamic loads of the keel and rig. This cradle is bolted to the bulkheads and a system of fibre glass beams.

The keel is made with an antimony-hardened lead bulb bolted to a cast iron fin, giving the keel a very low centre of gravity. The fin is protected by a layer of glass fibre faired to a smooth finish. The keel is directly mounted to the steel beam with 10 x 20 mm stainless steel bolts.

The interior is made in Kaya mahogany, varnished to a satin finish.

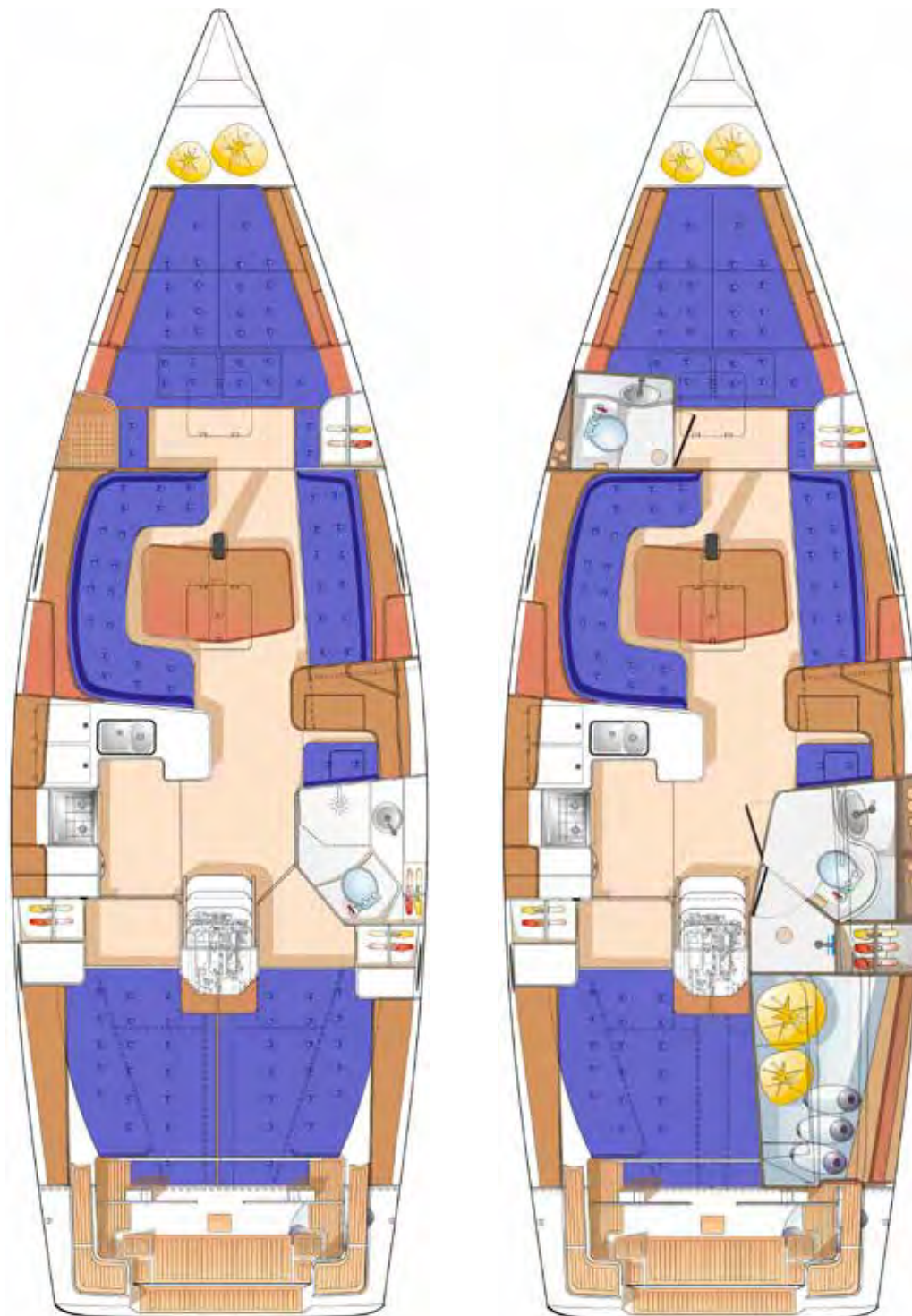

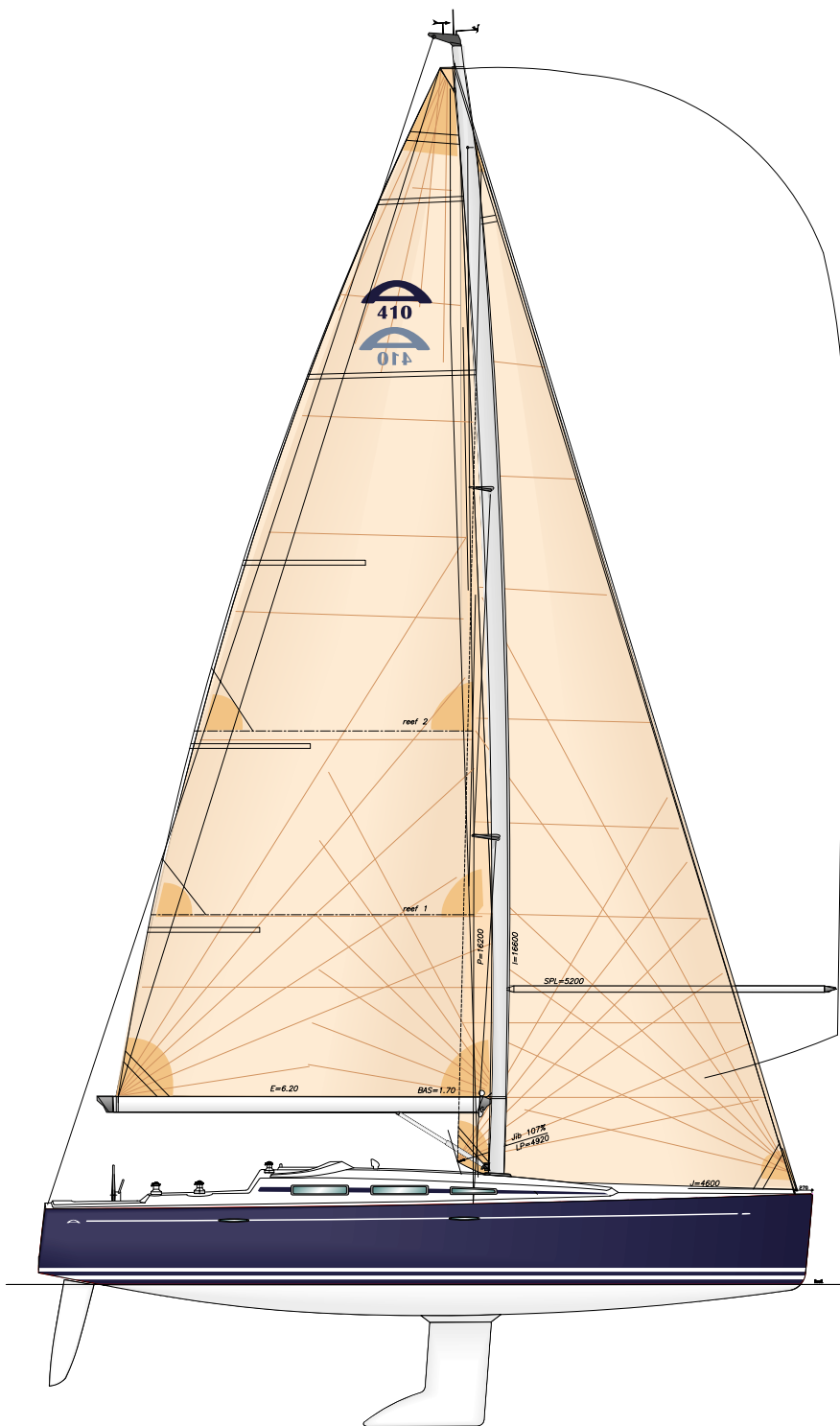

VPP

Jib (107%), spinnaker 148 m²

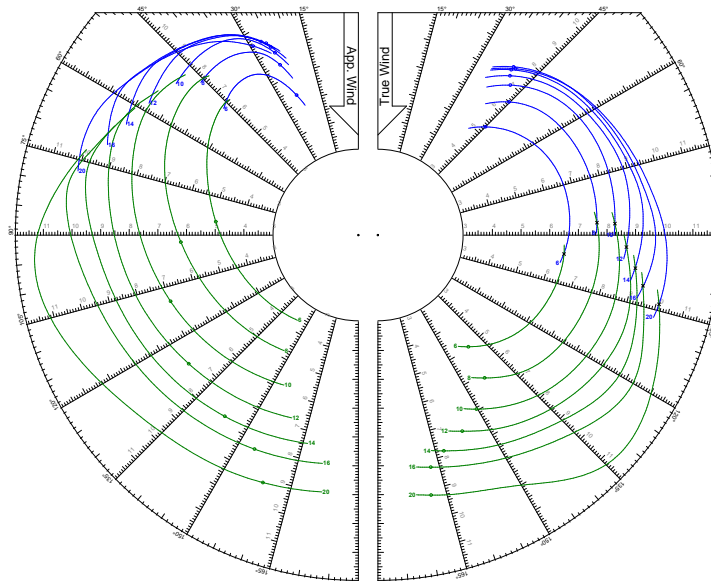

Polar Plot for Boat
 Name A410
 Sail Number SWE 1
 Class Arcona
 Designer S Qviberg
 Builder Arcona
 Issued On 06/02/2014 - VPP 2011 1.02

TWS: 6, 8, 10, 12, 14, 16, 20 kts
 Jib
 Symmetric Spinnaker

Specification

Mastheight over water	19,80 m
LOA	12,20 m
LWL	11,20 m
Beam	3,90 m
Draft	(2,00) 2,25 (2,50 m)
Displacement	7,8 ton
Ballast	2,6 ton
Main	57 m ²
Jib (107%)	45 m ²
Spinnaker	148 m ²
Gennaker	132 m ²
Water	220 lit
Hotwater	25 lit
Fuel	180 lit
Holdingtank	75 lit
Motor Yanmar	39 hk/3 JH5
I	16,60 m
J	4,55 m
P	16,20 m
E	5,85 m
LP (107%)	4,92 m
CE-Category	A
SRS	1.372
Design	Stefan Qviberg

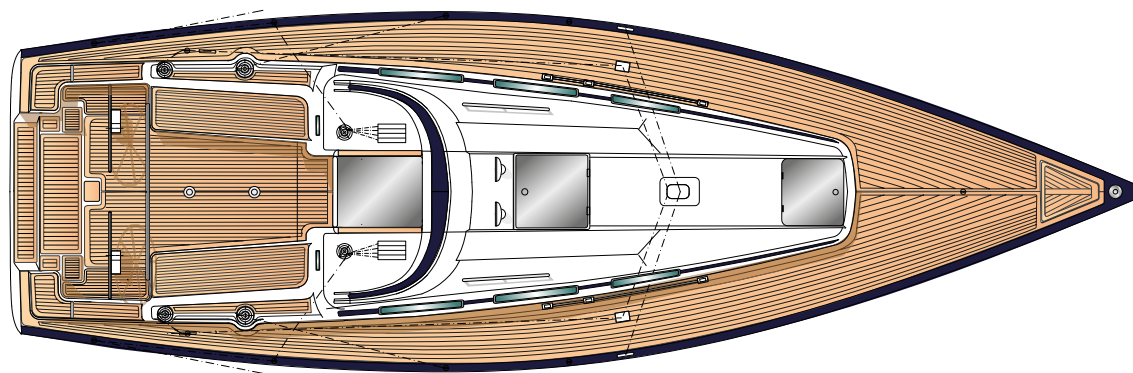

B&G

UK
SYVERSEN

SELDÉN

YANMAR
Yanmar Marine Engines

Swedbank
Finans

Sailboat
Sailboat & Boat



Arcona Yachts AB reserves the right to alter without notice the specification, design and equipment. Edition 20140815@Arcona Yachts AB. Photo: Stefan Almers © Studio Tranan AB

Arcona
yachts

340

380

410

430

460

Adress
Kattholmen
S-134 40 Gustavsberg
Sweden

Web
www.arconayachts.se

E-mail
info@arconayachts.se

Phone
+46 (0)8 570 346 77

Fax
+46 (0)8 570 346 29